

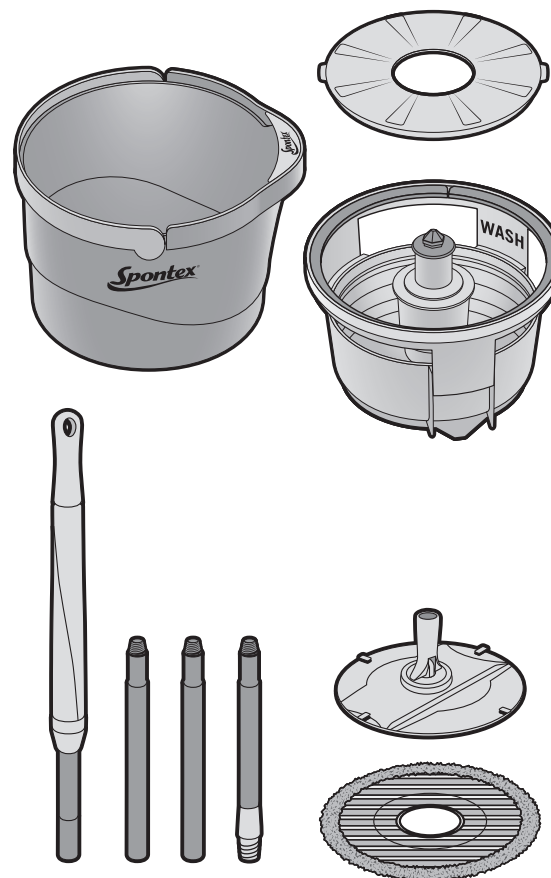

# Usage Instructions

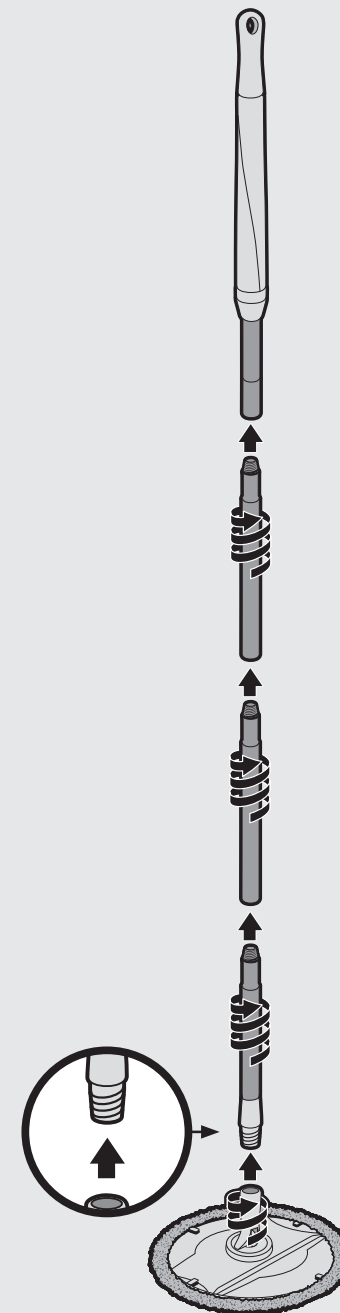

BOX CONTENTS



MOP ASSEMBLY

1

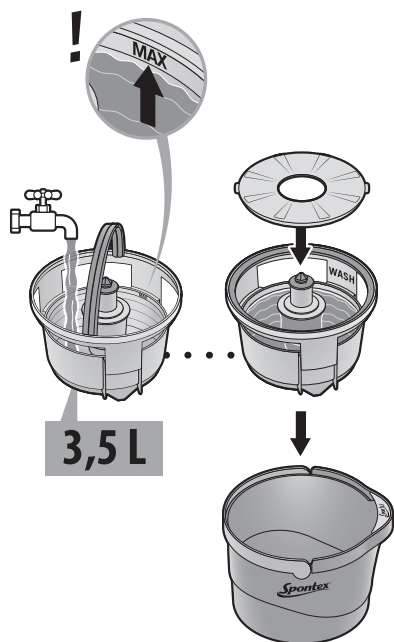

Fill the clean water compartment with just water or add your usual detergent (follow the detergent's dosage instructions) up to the MAX level, pop on the lid and then put it back in the main bucket.

2

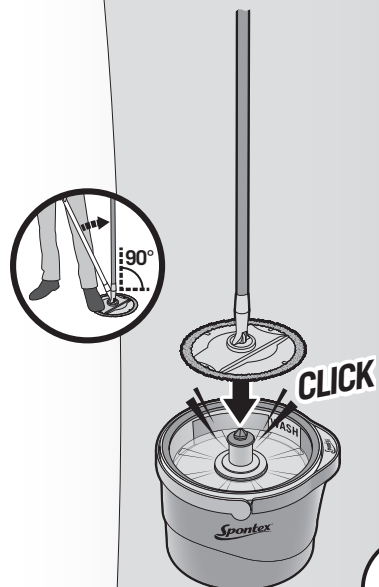

Place the mop on the pump and push down the handle until you hear the click.

3

RINSE ... AUTO ... WRING

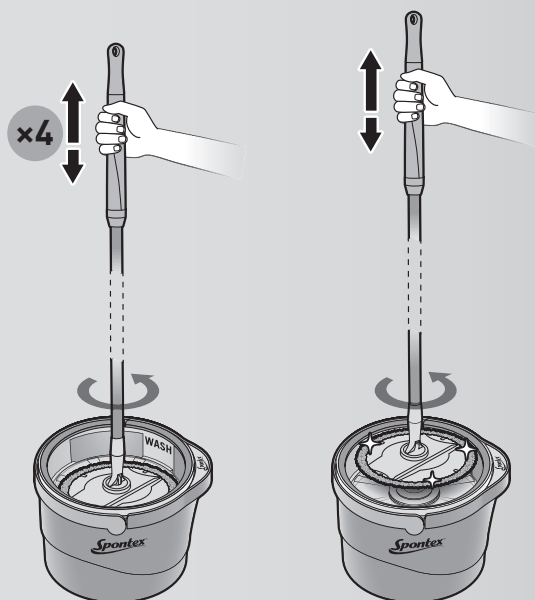

With the handle unlocked, push down and pull up the handle to dampen or rinse the mop. When the mop comes up automatically, wring as required repeating the same gesture.

4

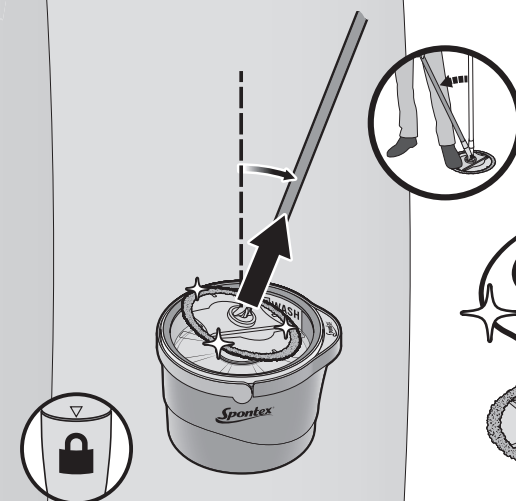

Tilt the mop slightly to unplug it. Adjust the height of the handle and lock it in place.

5

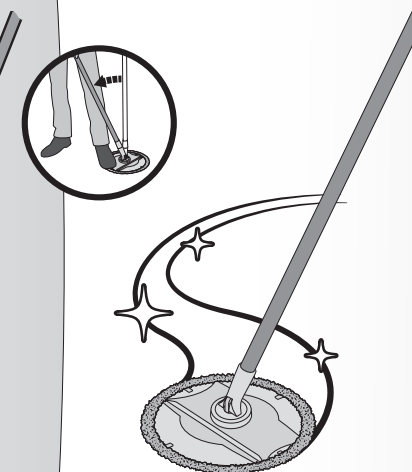

Pull the handle towards you and you'll then be ready to mop!

# AQUA REVOLUTION system

## TIPS & FEATURES

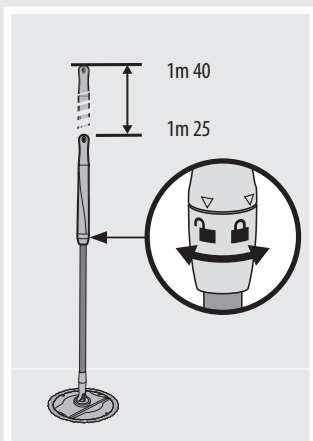

TELESCOPIC HANDLE

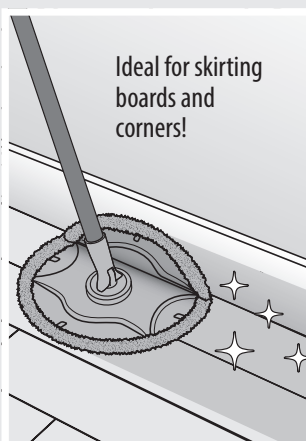

FOLDABLE HEAD

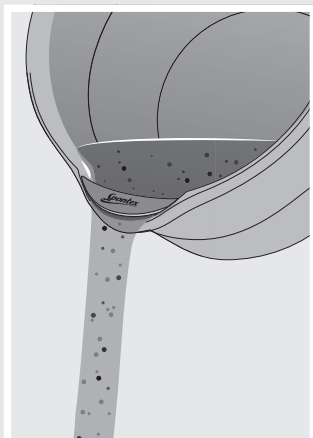

EASY TO EMPTY

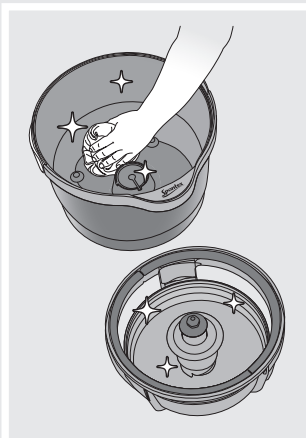

EASY TO CLEAN AFTER USE

## Microfibre

100% Polyester

90% Polyester,  
10% Polyamide

100% Polyamide

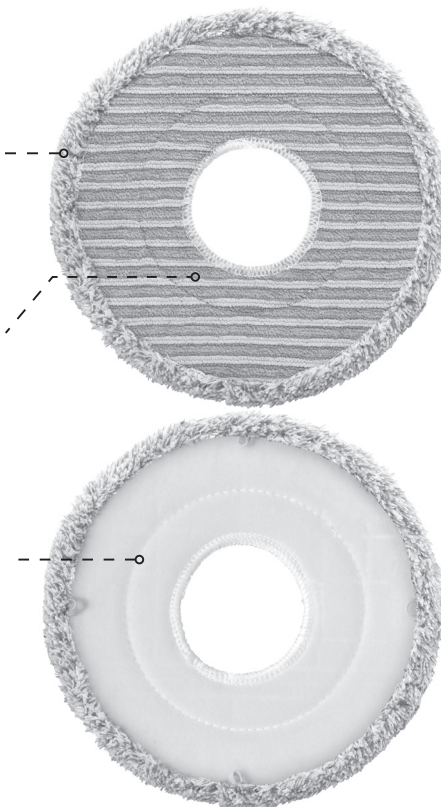

## CARE INSTRUCTIONS



After each use, machine wash up to 40°C without softener or bleach. Do not tumble dry.



Spare refills can be purchased separately so you can have one on the go and one in the wash!

**Spontex**

**AQUA  
REVOLUTION  
system**

**SEPARATES  
CLEAN  
& DIRTY WATER**

— MOP WITH —  
100% CLEAN WATER



Scan the QR code to see  
the system in action!

MAPA SPONTEX UK Ltd., Berkeley Business Park, Worcester, WR4 9ZS  
[www.spontex.co.uk](http://www.spontex.co.uk)